

# 1 New Jersey Avenue Streetscape

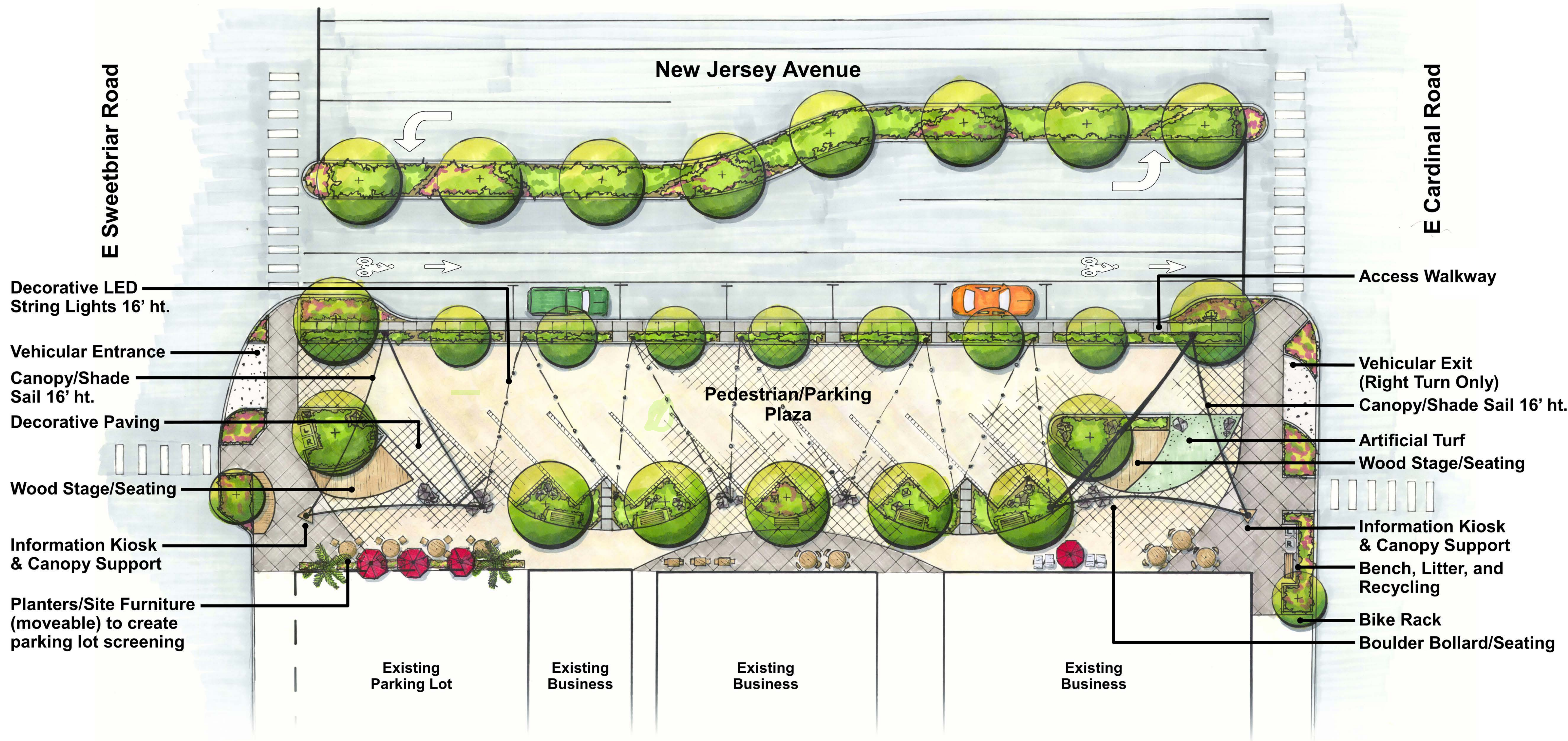

Borough of Wildwood Crest, Cape May County NJ  
July 15, 2021

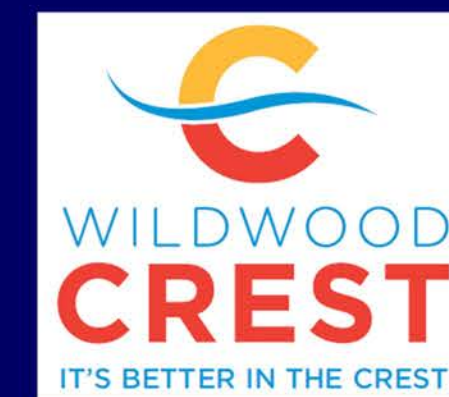

## Conceptual Layout Plan - Plaza/Parking Option

Prepared by Taylor Design Group, Inc.  
Mount Laurel, NJ  
Scott D. Taylor, ILLA, AICP, PP, LEED AP

