

PROJECT INFORMATION:
 FILE PATH: C:\Projects\CAPMA\00024\Plans\
 FILE NAME: CAPM00024_SHT020-SHT022_SSP.dwg
 DATE: 2/23/2023 1:22PM
 LAST SAVE BY: JMB

COPYRIGHT 2023, T&M ASSOCIATES - ALL RIGHTS RESERVED
 THE COPYING OR REUSE OF THIS DOCUMENT, OR PORTIONS THEREOF, FOR OTHER THAN THE ORIGINAL PROJECT OR
 THE PURPOSE ORIGINALLY INTENDED, WITHOUT THE WRITTEN PERMISSION OF T&M ASSOCIATES, IS PROHIBITED.

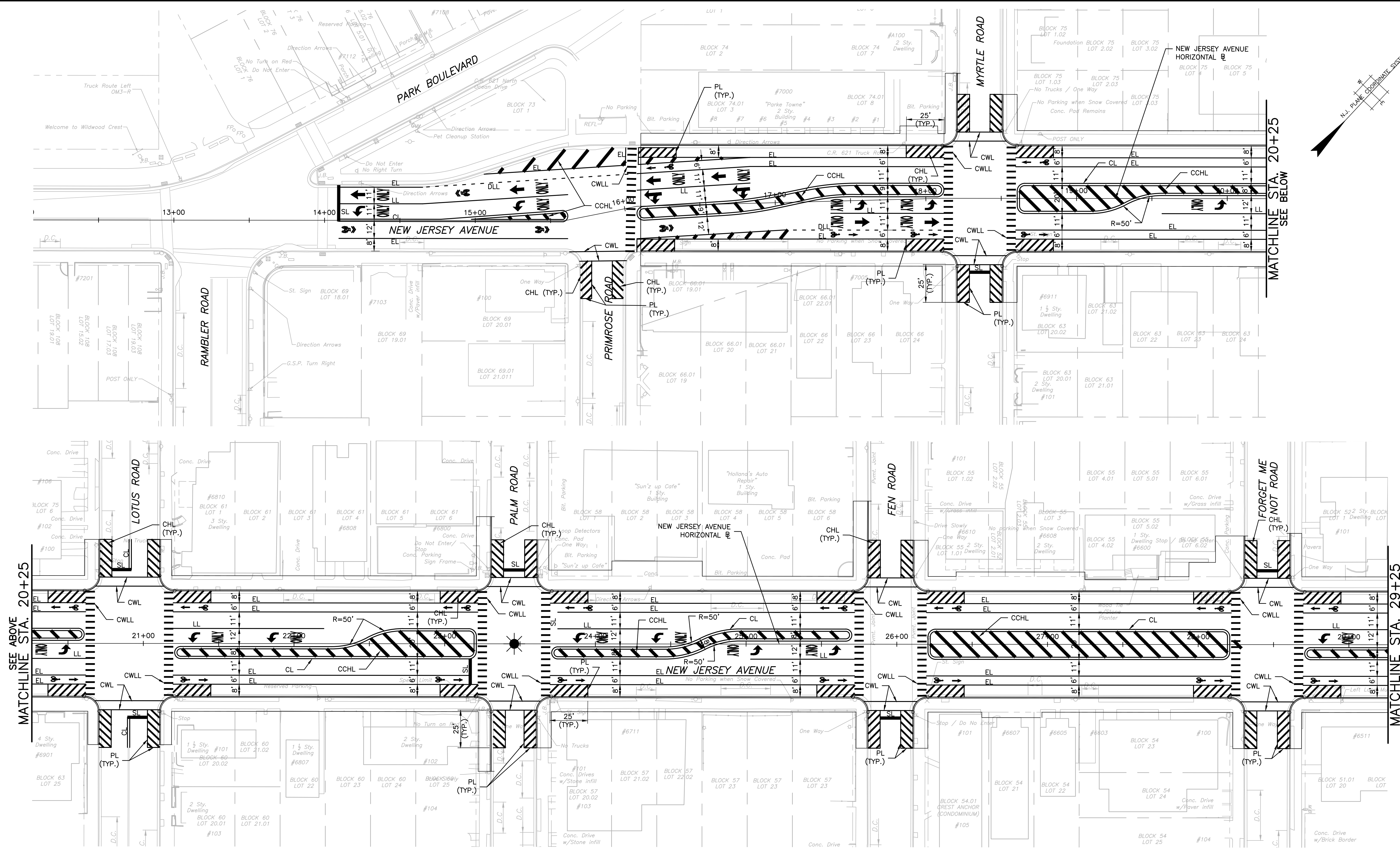
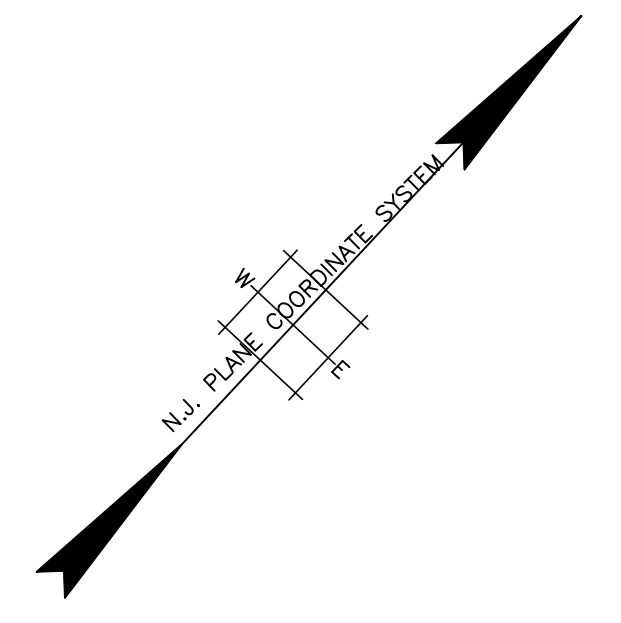

PAVEMENT MARKING LEGEND
 UNLESS OTHERWISE SHOWN, STRIPING SHALL CONFORM TO THE FOLLOWING:

PAVEMENT STRIPING	MATERIAL	DESCRIPTION	LEGEND
CENTER LINE	EPOXY-RESIN	2"-4" WIDE YELLOW, SEPARATED 6"	CL
CROSSWALK LINE	THERMOPLASTIC	6" WIDE WHITE, SPACED 6 FEET APART	CWL
CROSSWALK LONGITUDINAL LINE	THERMOPLASTIC	12" WIDE WHITE, 3' INTERVAL SPACING	CWLL
CROSS HATCH LINES	THERMOPLASTIC	12" WIDE YELLOW, AT 45°, 4' INTERVAL SPACING	CHL
CENTER CROSS HATCH LINES	THERMOPLASTIC	24" WIDE YELLOW, AT 45°, 12' INTERVAL SPACING	CCHL
DASHED LANE LINE	EPOXY-RESIN	4" WIDE WHITE, 10' LONG, 30' SPACE	DLL
EDGE LINE	EPOXY-RESIN	4" WIDE WHITE	EL
LANE LINES	EPOXY-RESIN	4" WIDE WHITE	LL
STOP LINE	THERMOPLASTIC	24" WIDE WHITE	SL

LEGEND

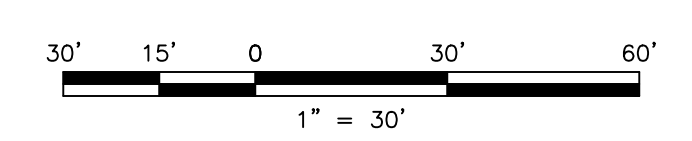
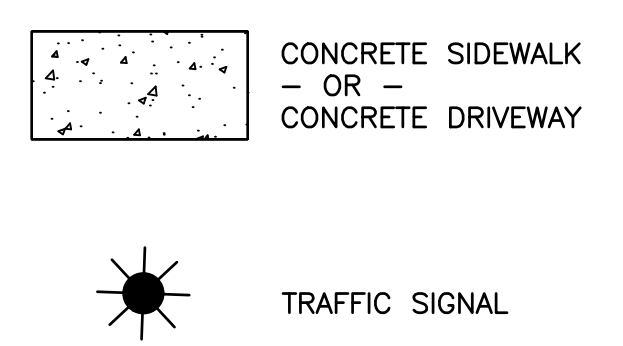

NO.	DATE	REVISIONS	BY	CHECKED

11 TINDALL ROAD
 MIDDLETOWN, NJ 07748
 TEL: 732-671-6400
 FAX: 732-671-7385
 www.tandmassociates.com
 NEW JERSEY BOARD OF PROFESSIONAL ENGINEERS
 AND LAND SURVEYORS
 CERTIFICATE OF AUTHORIZATION 26A2789750

COUNTY OF CAPE MAY
NEW JERSEY AVENUE ROADWAY IMPROVEMENTS
 BOROUGH OF WILDWOOD CREST,
 COUNTY OF CAPY MAY NEW JERSEY

TRAFFIC STRIPING PLANS

PAUL J. CINKO, P.E.
 CONSULTING ENGINEER

LICENSED PROFESSIONAL ENGINEER
 STATE OF NJ LICENSE No. 24GE03705600

SHEET
20
 OF 47

SEE ABOVE
 MATCHLINE STA. 20+25

MATCHLINE STA. 29+25
 SEE SHEET SSP-2

MATCHLINE STA. 20+25
 SEE BELOW

PROJECT INFORMATION:
 FILE PATH: C:\Projects\CAPMA\00024\Plans\
 FILE NAME: CAPM00024_SHT020-SHT022_SSP.dwg
 DATE: 11/15/2023 11:22 AM
 LAST SAVE BY: JMB

COPYRIGHT 2023, T&M ASSOCIATES - ALL RIGHTS RESERVED. FOR OTHER THAN THE ORIGINAL PROJECT OR THE COPYING OR REUSE OF THIS DOCUMENT, OR PORTIONS THEREOF, FOR OTHER THAN THE ORIGINAL PROJECT OR THE PURPOSE ORIGINALLY INTENDED, WITHOUT THE WRITTEN PERMISSION OF T&M ASSOCIATES, IS PROHIBITED.

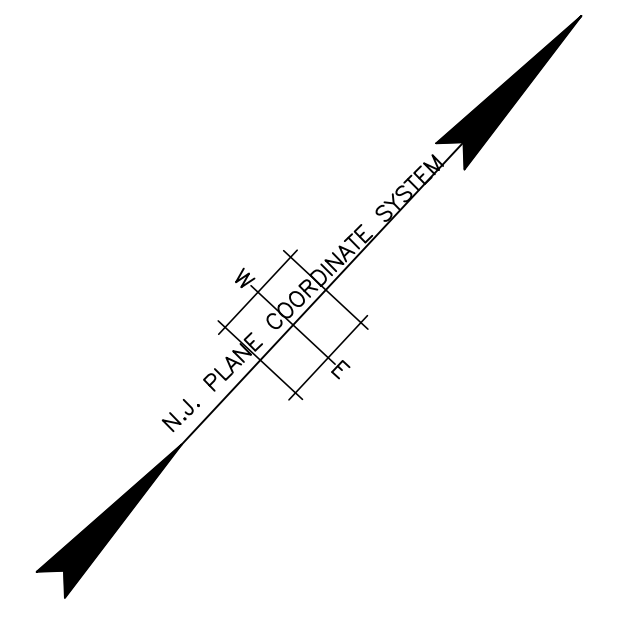
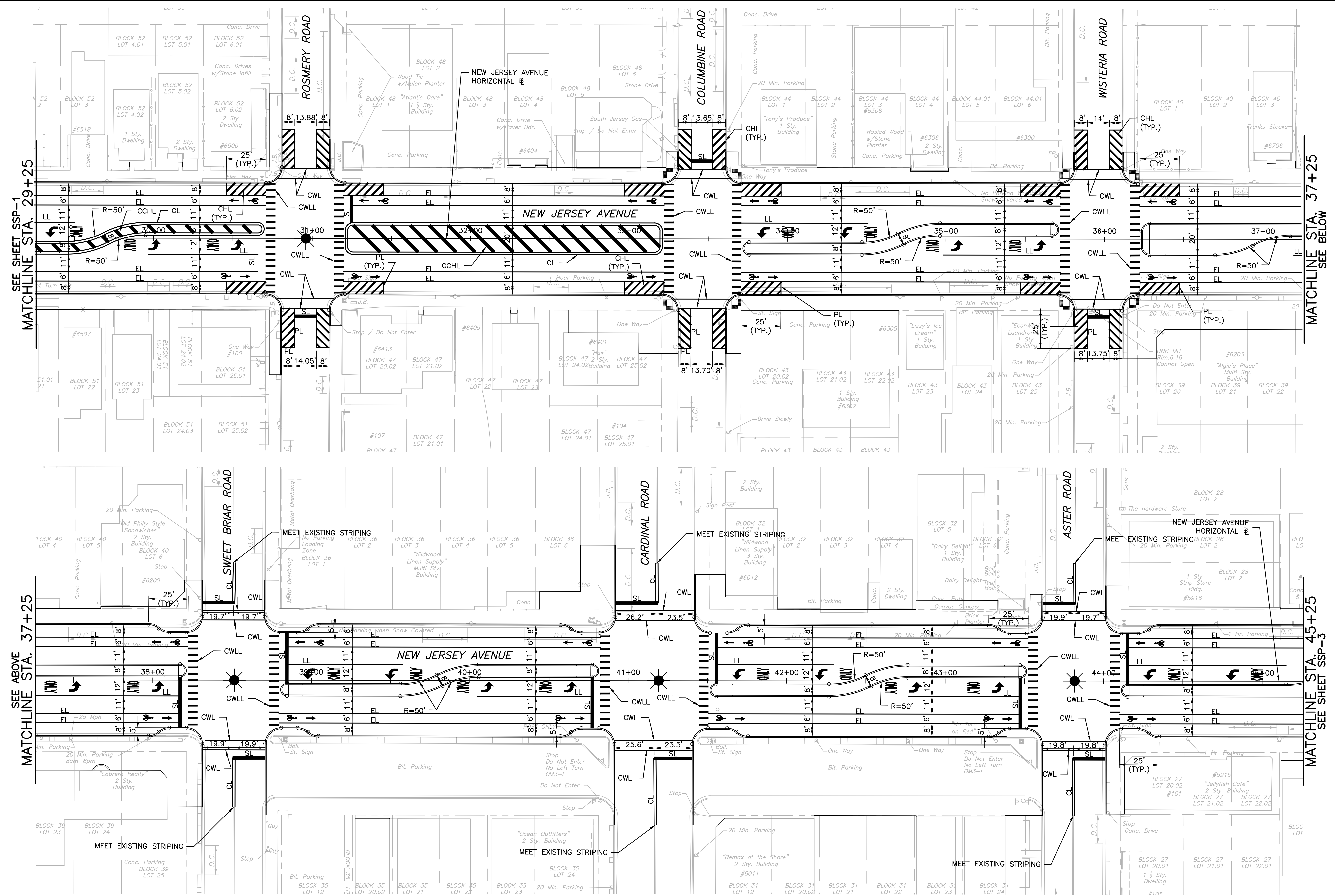

PAVEMENT MARKING LEGEND

UNLESS OTHERWISE SHOWN, STRIPING SHALL CONFORM TO THE FOLLOWING:

PAVEMENT STRIPING	MATERIAL	DESCRIPTION	LEGEND
CENTER LINE	EPOXY-RESIN	2"-4" WIDE YELLOW, SEPARATED 6"	CL
CROSSWALK LINE	THERMOPLASTIC	6" WIDE WHITE, SPACED 6 FEET APART	CWL
CROSSWALK LONGITUDINAL LINE	THERMOPLASTIC	12" WIDE WHITE, 3' INTERVAL SPACING	CWLL
CROSS HATCH LINES	THERMOPLASTIC	12" WIDE YELLOW, AT 45°, 4' INTERVAL SPACING	CHL
CENTER CROSS HATCH LINES	THERMOPLASTIC	24" WIDE YELLOW, AT 45°, 12' INTERVAL SPACING	CCHL
DASHED LANE LINE	EPOXY-RESIN	4" WIDE WHITE, 10' LONG, 30' SPACE	DLL
EDGE LINE	EPOXY-RESIN	4" WIDE WHITE	EL
LANE LINES	EPOXY-RESIN	4" WIDE WHITE	LL
STOP LINE	THERMOPLASTIC	24" WIDE WHITE	SL

LEGEND

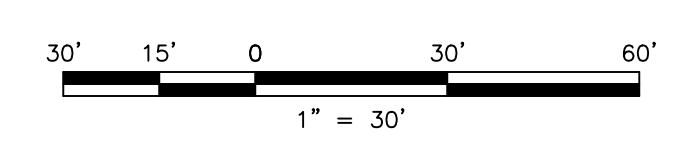
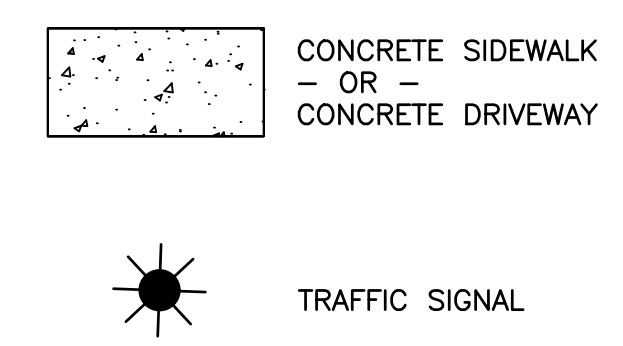

NO.	DATE	REVISIONS	BY	CHECKED



11 TRINDALL ROAD
 MIDDLETOWN, NJ 07748
 TEL: 732-671-6400
 FAX: 732-671-7865
 www.tandmassociates.com
 NEW JERSEY BOARD OF PROFESSIONAL ENGINEERS
 AND LAND SURVEYORS
 CERTIFICATE OF AUTHORIZATION 24G03705600

COUNTY OF CAPE MAY

NEW JERSEY AVENUE ROADWAY IMPROVEMENTS

BOROUGH OF WILDWOOD CREST,
 COUNTY OF CAPY MAY NEW JERSEY

TRAFFIC STRIPING PLANS

PAUL J. CINKO, P.E.
 CONSULTING ENGINEER

SHEET
21
 OF 47

LICENSED PROFESSIONAL ENGINEER
 STATE OF NJ LICENSE No. 24GE03705600

TSP-2

PROJECT INFORMATION:
 FILE PATH: C:\Projects\CAPMA\00024\Plans\
 FILE NAME: CAPMA00024_SHT020-SHT022_SSP.dwg
 LAST SAVE BY: JMB
 LAST SAVE TIME: 23 Feb 2023, 1:22PM

COPYRIGHT 2023, T&M ASSOCIATES - ALL RIGHTS RESERVED.
 THE COPYING OR REUSE OF THIS DOCUMENT, OR PORTIONS THEREOF, FOR OTHER THAN THE ORIGINAL PROJECT OR
 THE PURPOSE ORIGINALLY INTENDED, WITHOUT THE WRITTEN PERMISSION OF T&M ASSOCIATES, IS PROHIBITED.

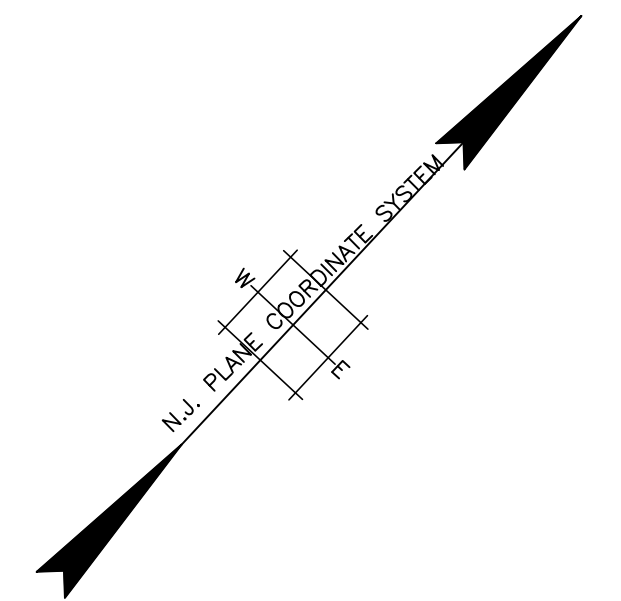
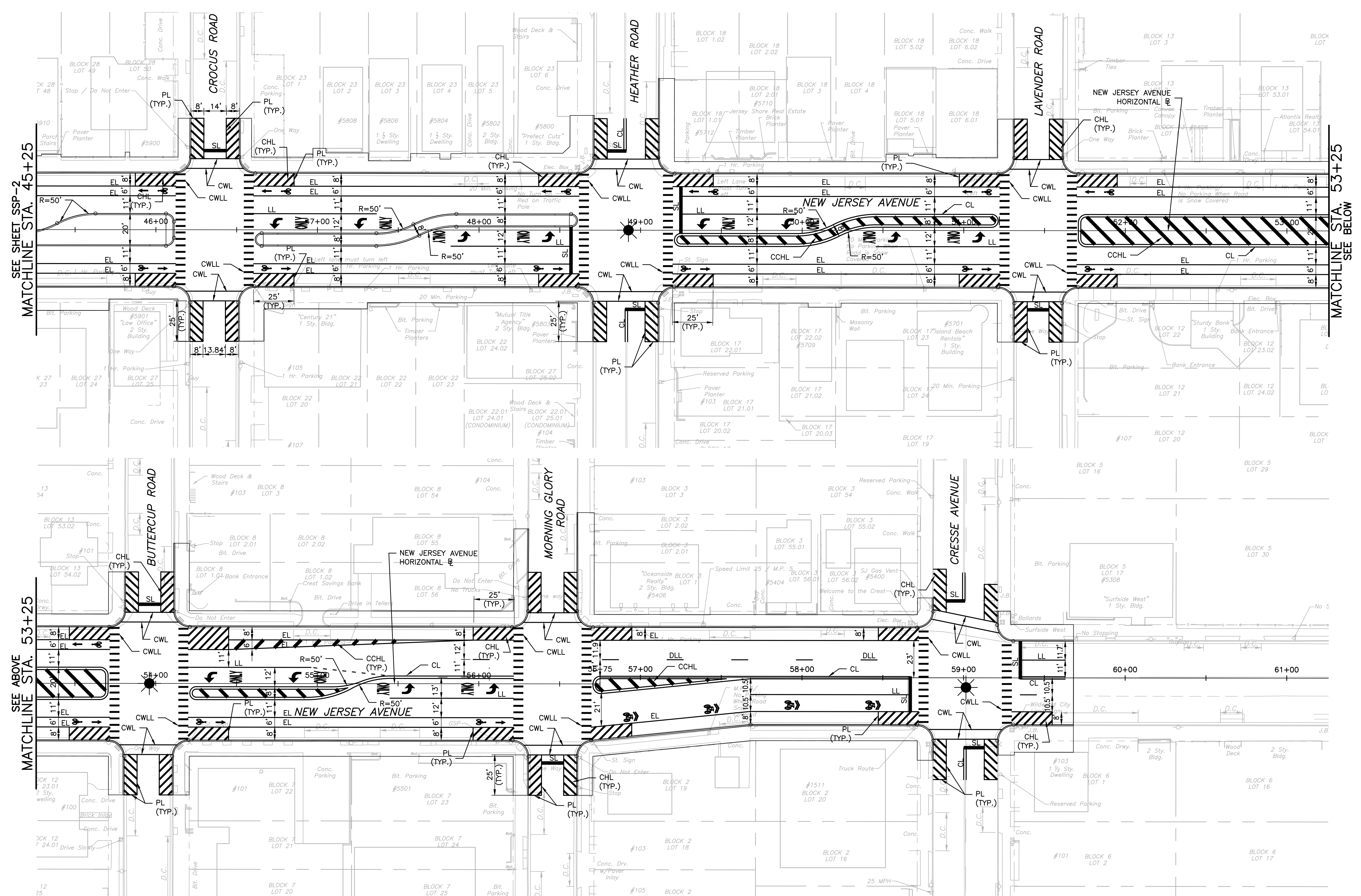

PAVEMENT MARKING LEGEND
 UNLESS OTHERWISE SHOWN, STRIPING SHALL CONFORM TO THE FOLLOWING:

PAVEMENT STRIPING	MATERIAL	DESCRIPTION	LEGEND
CENTER LINE	EPOXY-RESIN	2"-4" WIDE YELLOW, SEPARATED 6"	CL
CROSSWALK LINE	THERMOPLASTIC	6" WIDE WHITE, SPACED 6 FEET APART	CWL
CROSSWALK LONGITUDINAL LINE	THERMOPLASTIC	12" WIDE WHITE, 3' INTERVAL SPACING	CWLL
CROSS HATCH LINES	THERMOPLASTIC	12" WIDE YELLOW, AT 45°, 4' INTERVAL SPACING	CHL
CENTER CROSS HATCH LINES	THERMOPLASTIC	24" WIDE YELLOW, AT 45°, 12' INTERVAL SPACING	CCHL
DASHED LANE LINE	EPOXY-RESIN	4" WIDE WHITE, 10' LONG, 30' SPACE	DLL
EDGE LINE	EPOXY-RESIN	4" WIDE WHITE	EL
LANE LINES	EPOXY-RESIN	4" WIDE WHITE	LL
STOP LINE	THERMOPLASTIC	24" WIDE WHITE	SL

LEGEND

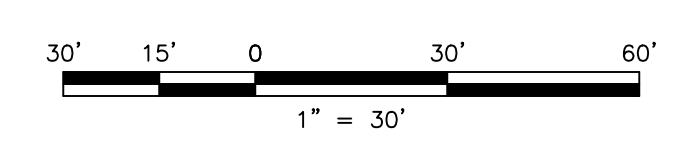
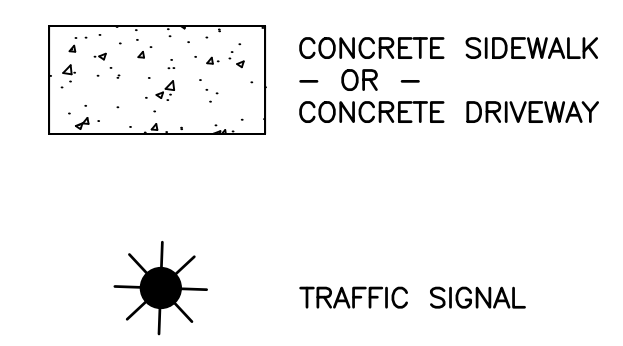

11 TINDALL ROAD
 MIDDLETOWN, NJ 07748
 TEL: 732-671-6400
 FAX: 732-671-7885
 www.tandmassociates.com
 NEW JERSEY BOARD OF PROFESSIONAL ENGINEERS
 AND LAND SURVEYORS
 CERTIFICATE OF AUTHORIZATION 26A2799760

COUNTY OF CAPE MAY	
NEW JERSEY AVENUE ROADWAY IMPROVEMENTS	
BOROUGH OF WILDWOOD CREST, COUNTY OF CAPY MAY NEW JERSEY	
TRAFFIC STRIPING PLANS	
PAUL J. CINKO, P.E. CONSULTING ENGINEER	
LICENSED PROFESSIONAL ENGINEER STATE OF NJ LICENSE No. 24GE03705600	

NO.	DATE	REVISIONS	BY	CHECKED

SHEET
22
 OF 47